

# 2016 Arkansas Home Visiting Network Conference



# Celebrating Stronger Families Brighter Futures

August 25-26, 2016 • Embassy Suites • Little Rock, AR



Stronger Families.  
Brighter Futures.

ARKANSAS HOME VISITING NETWORK

# Conference Overview



Stronger Families.  
Brighter Futures.

ARKANSAS HOME VISITING NETWORK

## WORKSHOP

## ROOM ASSIGNMENT

THURSDAY August 25, 2016			
		<b>MODEL SPECIFIC MEETINGS</b>	
	1:00 – 4:00 pm	Following Baby Back Home	Diplomat
	1:00 – 4:00 pm	Healthy Families America	Consulate I-II
	9:00 am – 4:00 pm	HIPPY	Ambassador I-II
	1:30 – 4:00 pm	Nurse Family Partnership	Envoy
	1:00 – 4:00 pm	Parents as Teachers	Ambassador V-VI
	5:30 – 8:30 pm	<b><i>SOCIAL and Celebrating HIPPY's 30<sup>th</sup> Anniversary</i></b>	Ambassador I-IV
FRIDAY August 26, 2015			
	8:30 – 9:45 am	<b>GENERAL SESSION</b>	Ambassador III-IV
	10:00 – 11:15 am	<b>WORKSHOPS Session A</b>	
		The Amazing Teenage Brain	Ambassador V-VI
		The Impact of Toxic Stress on Today's Parents and Children	Ambassador I-II
		Navigating the Training Institute's Online Modules <i>(Ticketed Event)</i>	Diplomat
		Parent Panel: Group Discussion <i>(Ticketed Event)</i>	Consulate I-II
		Supervision with Professional Support and Development	Envoy
		Supporting Language Development for Deaf and Hard of Hearing Children	Ambassador VII
	11:15 am– 1:00 pm	<b>LUNCH/KEYNOTE</b>	Ambassador III-IV
	1:15 – 2:30 pm	<b>WORKSHOPS Session B</b>	
		Get Your Act Together! Organization Hacks	Ambassador I-II
		Need a Doctor? Connecting Families to a Medical Home	Diplomat
		Leadership and Team Building <i>(Ticketed Event)</i> <b>Supervisors, Coordinators, Directors Only (1:15 – 4:00 pm)</b>	Ambassador V-VI
		See the World Through My Eyes	Consulate I-II
		Self – Care	Ambassador VII
		Strengthening Families Protective Factors Framework: Parental Resilience	Envoy
	2:45 – 4:00 pm	<b>WORKSHOPS Session C</b>	
		Another Day...Another Visit	Consulate I-II
		Attitude is Everything	Envoy
		Group – Ease	Ambassador VII
		Infant and Early Childhood Mental Health in Home Visiting	Diplomat
		Managing Stress: Turning Challenges Into Blessings	Ambassador I-II

\* Please Note - Room assignments are subject to change – check for the Workshop Session Title outside of the room

# Welcome to the Celebration!

I would like to personally welcome you to the 2016 Arkansas Home Visiting Network Conference. We are excited to host our 3rd annual conference exclusively for home visitors, home based educators, parent educators, supervisors and coordinators. Our conference theme this year is "Celebrating Stronger Families Brighter Futures." We are not only celebrating HIPPPY's 30th Anniversary but we are celebrating YOU as a home visitor who works diligently with families to help them become stronger and create brighter futures for children in Arkansas.

The Conference Committee has planned a conference to provide you with skills, knowledge, and networking opportunities to better equip you to work more effectively with your families. Gaining knowledge through professional development opportunities such as this conference will benefit you as you work with families who depend on you to help guide them



as parents.

I'd like to thank each of YOU for attending and adding your expertise to our conference. You, have the vision, the knowledge, and the experience to help us pave the way for STRONGER FAMILIES and BRIGHTER FUTURES in Arkansas. You are truly an

important asset to families today and tomorrow.

If you have any comments, or suggestions for next year's conference please be sure to participate in the Survey Monkey evaluation that will be sent to each of you after the conference.

Enjoy the conference!

Nick Long, Director

Arkansas Home Visiting Network Training Institute

## SCOTT GORDON ARKANSAS HOME VISITING PROFESSIONAL OF THE YEAR AWARD

The Scott Gordon Arkansas Home Visiting Professional of the Year award was established for the purpose of annually recognizing an individual that is making an outstanding contribution, through home visiting, to building stronger families and brighter futures for the children and communities of Arkansas. Those eligible for the award include all home visitors, home-based educators, parent educators, administrators, supervisors, & coordinators who work in home visiting programs in Arkansas.

Our families deserve the best and because of the exceptional efforts of home visiting staff throughout the state, they receive the best! We want to recognize and honor an individual who does an outstanding job of helping equip families to help their children achieve their greatest potential.

### Past Winners

Deena Tougaw	2014
Onika Gibson-Lovett	2015

### 2016 Nominees

Laura Alvarado	Jennier Keys
Copresia Austin	Laura Landrum
Amanda Baldwin	Jaclyn Beth Massey
Regina Black	Sara McCandlis
Trudy Boatman	Lindsey McDonald
DeAnna Borr	Jeannie Milburn
Becky Dodson	Glenda Nelson
Jessica Doherty	Sylvia D Spencer
Karen Garner	Ashley Temple
Jennifer Gladden	Maria Towery
Silvia Hughes	Casey Tyrone
Tenisha Jarrett Waits	Angie Whatley
Tracy Kennedy	Lanea Yandell

# Conference Schedule

## THURSDAY

August 25, 2016

8:00 am – 10:00 am

**Conference Check In**

12:00 pm – 2:00 pm

**Conference Check In**

9:00 am – 4:00 pm

**MODEL SPECIFIC MEETINGS** (times determined by each model lead)

HIPPY (Supervisors/Coordinators)

1:00 – 4:00 pm

FBBH, HFA, and PAT

1:30 – 4:00 pm

NFP

5:30 – 8:30 pm

**SOCIAL & HIPPY 30th Anniversary Celebration**

ALL ARE INVITED Come and Enjoy the Celebration

Welcome - Dr. Miriam Westheimer

## FRIDAY

August 26, 2016

7:30 – 8:30 am

**Conference Check In**

8:30 – 9:45 am

**GENERAL SESSION**

**A. Welcome**

Bradley Planey, *Branch Chief, Family Health Branch,  
Arkansas Department of Health*

Dr. Kathy Pillow Price, *Arkansas Children's Hospital*

**B. "Finding Your People"**

Dr. Kathy Pillow Price, *Director, AHVN*

**C. Presentation of the Scott Gordon Arkansas Home Visiting  
Professional of the Year Award**

Jennifer Medley, *Home Visiting Section Chief,  
Arkansas Department of Health*

9:45 – 10:00 am

**BREAK**

# Conference Schedule

## FRIDAY continued

10:00 -11:15 am

### WORKSHOPS SESSION A

- A1. The Amazing Teenage Brain
- A2. The Impact of Toxic Stress on Today's Parents and Children
- A3. Navigating the Training Institute's Online Modules – ***Ticketed Event***
- A4. Parent Panel: Group Discussion – ***Ticketed Event***
- A5. Supervision with Professional Support and Development
- A6. Supporting Language Development for Deaf and Hard of Hearing Children

11:15 am – 1:00 pm

### LUNCH/KEYNOTE – ***Ticketed Event***

Dr. Kathleen Gallagher  
*"The Health and Wellbeing of Home Visitors"*

1:15 – 2:30 pm

### WORKSHOPS SESSION B

- B1. Get Your Act Together! Organization Hacks
- B2. Need a Doctor? Connecting Families to a Medical Home
- B3. Leadership and Team Building (*Runs Consecutively with Session C*) 1:15 – 4:00 pm – ***Ticketed Event***
- B4. See the World Through My Eyes
- B5. Self-Care
- B6. Strengthening Families Protective Factors Framework: Parental Resilience

2:30 – 2:45 pm

### BREAK

2:45 – 4:00 pm

### WORKSHOPS SESSION C

- C1. Another Day...Another Visit
- C2. Attitude is Everything
- C3. Group Ease
- C4. Leadership and Team Building (*continued from Session B*)
- C5. Infant and Early Childhood Mental Health in Home Visiting
- C6. Managing Stress: Turning Challenges Into Blessings



# General Conference Information

## NAME BADGE

Your name badge identifies you as a conference participant, therefore we request that you wear it at all times. All participants will have a ribbon below their badge identifying which home visiting program they serve. Please take the time to find someone from another program and network!

On the back of your name badge you will find a conference agenda for your convenience, along with a meal ticket. Your meal ticket will be necessary to enter the Lunch Keynote. Depending on your pre-registration, your badge may also include tickets for the Parent Panel, the Online Module Workshop, or the Leadership and Teambuilding Session for Supervisors, Coordinators, and Directors. At all four events, tickets will be taken at the door. Those without a ticket will not be permitted to enter due to capacity. Thank you for honoring our ticket system.

## MEALS and BREAKS

Please be prepared to present the appropriate ticket to the greeters at the door of Ambassador VI-VII. The ticket will be in the back of your badge when you check in. Please take advantage of breaks that are provided to allow time to freshen up, return messages, and have a snack (when provided).

## SCHEDULE

Time has been allotted to allow participants to find the appropriate room of the session they wish to attend. Please enter the room in a timely manner to find a seat and receive handouts (if provided). When the session meets capacity, a "Session Closed" sign will be placed outside the door. Please select another workshop. It is very distracting to the presenter and other participants for someone to enter after the workshop has started and look for a seat.

## EDUCATION CREDIT

A Training Document is included in your packet. Please complete the entire form and return to AHVN Staff before you leave the conference. Labels will be provided at the end of each workshop. Code words will be provided at the General Sessions.

## EXHIBITORS

Please take time to visit exhibitors that are located in the hallways.

## CHECK OUT TIME

Check out time for Embassy Suites is 11:00 am

## CELL PHONES

Please be considerate of your fellow conference participants and do not use your cell phone or text during the sessions. If you absolutely have to receive or make a call please quietly step out of the room. There are several breaks that are provided for you to utilize your phone.

## EVALUATIONS

Your feedback is important to us. Each session will have evaluation forms provided to you - please take a few minutes of your time and complete the entire form. Please hand to the facilitator as you exit the room. After the conference you will receive an invitation from Survey Monkey to complete a short overall conference evaluation. Information collected is our "blueprint" for next year's conference! We need your feedback to plan the conference for next year.

**#AHVN2016**

# Featured Speakers

## Dr. Kathleen Gallagher

Kathleen (Kate) Gallagher, Ph.D. is an educational psychologist and early childhood professional, with over 30 years experience teaching and leading early childhood programs. Dr. Gallagher designs and evaluates interventions that support the development and wellbeing of young children, families, and early childhood professionals. Her research and professional guidance have been published in books, journals and media publications. Dr. Gallagher's ability to communicate messages regarding high quality early care and education are manifest in presentations and workshops with a wide range of audiences, including UNC's most popular TED talk of 2015: *The Healthy Child: Assembly Required* and *TEDxMemphis: Assembly of the Healthy Child: The Next Steps*.



## Dr. Miriam Westheimer Coach Sidney Moncrief



Dr. Miriam Westheimer has worked in the fields of education, social service and nonprofit management serving as a founding executive director, international director, board president, project manager and organizational/educational consultant.

She has spent the last 20 years adapting and disseminating a home-based, early childhood program (HIPPI). She served HIPPI as the founding executive director and later built the interna-

tional network of HIPPI programs among the 12 participating countries.

She has a small consulting practice that allows her to work with diverse organizations and individuals as advisor, mentor, manager and facilitator. Her consulting clients include Arkansas Children's Hospital, Carnegie Corporation of New York, Family Support America, Families and Work Institute, The Finance Project, Jewish Theological Seminary of America and Quality Evaluation Design.

Dr. Westheimer co-authored the best-selling international textbook and multi-media series, *Focus on Grammar*, now in its third edition. Additionally, based on her experience teaching English in Israel, she helped conceive and create a global course to teach teen-agers and adults how to communicate effectively in English.

Sidney Moncrief has served on the Board of Directors for a Fortune 500 company and as president of various retail auto sales businesses. He is a five-time NBA All-Star, five-time member of the NBA All-Defensive team, a two-time NBA Defensive Player of the Year, and an NBA All-Pro. He is a former head coach and assistant coach. As a coach, Sidney Moncrief has served on the coaching staff of the Dallas Mavericks, Golden State Warriors and the Milwaukee Bucks. He also led an international team as the head consultant in Beijing, China.

Sidney is author of four books: *Sidney Moncrief: My Journey to the NBA*; *Your Passport to Reinventing You*; *Your Passport to Becoming a Valuable Team Player*; *Your Passport to Back2Basics Leadership* and the soon to be released *Your Passport to Manhood*.

He is currently managing partner of Moncrief1Team, which is a People Building Company specializing in Team Enhancement and Leadership training.



# Session A Workshops 10:00–11:15 am

## A1: The Amazing Teenage Brain

### CORE COMPETENCY: CHILD DEVELOPMENT

Have you ever wondered why teens act the way they do? It is not because they are crazy, but because the rapidly changing wiring in their brain is far from complete, leading to risky behaviors but also highly adaptive brain functioning! This workshop will review current research on the teenage brain and provide gender-based strategies for engaging, communicating and supporting these amazing adolescents! Participants will leave this workshop with 3-5 strategies for communicating more effectively with teenagers.

*Presenter: Cathy Hagemeier, M.Ed.  
MidSOUTH Training Academy, UALR School of Social Work*

## A2: The Impact of Toxic Stress on Today's Parents and Children

### CORE COMPETENCY: PARENTAL WELL BEING AND STABILITY

This workshop will focus on understanding the profound impact of toxic stress on today's parents and children. It will review the scientific basis for this and the need for changing our approach. Toxic stress is a root cause of many of today's public health problems.

*Presenter: Alan Mease, MD  
Arkansas Department of Health*

## A3: Navigating the Training Institute's Online Modules

*All attendees must bring a mobile device to participate (e.g. laptop, tablet or phone)*

*Class size limited to 20 people (Ticketed Event)*

### CORE COMPETENCY: PROFESSIONAL GROWTH AND LEADERSHIP

This hands-on workshop will provide participants with a complete overview of the process required to access, enroll, and successfully navigate an online course offered through the AHVN Training Institute. Participants must bring a mobile device to attend. FREE WI-FI is available.

*Presenters: Donna Carter, M.Ed.  
Arkansas Home Visiting Network Training Institute*

## A4: Parent Panel: Group Discussion

*(Ticketed Event)*

### CORE COMPETENCY: METHODS AND APPROACHES TO WORKING WITH PARENTS

A moderated session to engage and inform home visiting on a broad range of issues from the parent's point of view. Gain a better understanding of how a home visitor can help recruit and retain parents.

*Sarah Coleman, MA, Facilitator  
Coordinated Intake Manager, Arkansas Children's Hospital*

## A5: Supervision with Professional Support and Development

### CORE COMPETENCY: PROFESSIONAL GROWTH AND LEADERSHIP

This workshop will discuss reflective strategies including dealing with boundaries, emotional triggers, home visitor boundaries, self-care/burnout, maximum caseload and case notes.

*Presenter: Reta Johnson, MS, CRC, CADC  
Healthy Families America, Centers for Youth & Families*

## A6: Supporting Language Development for Deaf and Hard of Hearing Children

### CORE COMPETENCY: CHILD DEVELOPMENT

Working with families through the hearing screening, diagnostic and intervention process can be complex and difficult. This workshop will provide information, strategies and resources for families and providers about hearing and the impact of hearing loss.

*Presenter: Karen K. Lange, Ed.S.  
Arkansas School for the Deaf*

# #AHVNVN2016



# Session B Workshops 1:15–2:30 pm

## **B1: Get Your Act Together! Organization Hacks**

**CORE COMPETENCY: PROFESSIONAL GROWTH & LEADERSHIP**

This hands on, interactive workshop will give practical tips and tricks to help identify where organization can be improved and promote smoother daily operations.

*Presenter: Dee Parson, B.A.*

*Arkansas Children's Hospital – Quitman HIPPY/PAT*

## **B3: Need a Doctor: Connecting Families to a Medical Home**

**CORE COMPETENCY: HEALTH & SAFETY**

Participants will learn to use ConnectCare website, phone service and resources to connect families to a medical home, which includes a Primary Care Physician (PCP) and dental provider. Participants will be given resources to use with clients to ensure they have the opportunity to access Medicaid services to get the medical care they need.

*Presenters: Ariel Schaufler, CHES and Shanetta Agnew MS*

*Arkansas Department of Health – ConnectCare*

## **B4: See the World Through My Eyes**

**CORE COMPETENCY: CHILD DEVELOPMENT**

The things you do make sense to you. You understand why you do them. The things children do make sense to the child. Each child is unique. In the first few years of a child's life, they learn many new skills: cooing, smiling, crawling, climbing, walking, talking, playing, sharing -- and grabbing, helping, spilling, hugging, etc. This presentation will offer insight into challenges, but through the eyes of a child.

*Presenters: Rebecca Simon and Dr. Brittney Schrick*

*University of Arkansas Cooperative Extension*

## **B5: Self-Care**

**CORE COMPETENCY: HEALTH & SAFETY**

Self-Care is simply caring about oneself and taking responsibility for you. Self-Care enables you to embrace that you are the only one responsible for your life, choices, and deeds. Most importantly, it is impossible to love others if you do not love yourself. Loving yourself gives you a sense of self-worth. It helps you concentrate on your strong points and work on your weaknesses and imperfections.

*Presenter: Laura Landrum*

*Healthy Families America*

*Centers For Youth and Families*

## **B6: Strengthening Families Protective Factors Framework: Parental Resilience**

**CORE COMPETENCY: DYNAMICS OF FAMILY RELATIONSHIPS**

This session will cover a unit from the Strengthening Families model. Activities will focus on identifying ways for caregivers to provide strategies and everyday actions to promote parental resilience.

*Presenters: Jenny Dura and Robin Jones, M.S.*

*University of Arkansas, Early Care and Education Projects*

# Leadership and Team Building 1:15–4:00 pm

*(This leadership workshop is open to supervisors, coordinators, and directors only. Ticketed Event.)*

**CORE COMPETENCY: PROFESSIONAL GROWTH & LEADERSHIP**

It's time to step up your game and transform your team into a partnership with interaction, mutual respect and trust. This workshop will involve an overview of the 7 principles for building your OneTeam: Trust, Communication, Responsibility, Respect, Resolve, Assisting, and Effort.

*Presenter: Coach Sidney Moncrief, OneTeam (and Basketball Great!)*

# Session C Workshops 2:45–4:00 pm

## C1. Another Day...Another Visit

**CORE COMPETENCY: PROFESSIONAL GROWTH & LEADERSHIP**

Another day...another visit. A home visit can either make or break your day. A well thought out, purposeful plan is the key to a successful home visit. This workshop will help guide you through the process of creating meaningful plans using a variety of materials and resources tailored to individual families. Purposeful planning will help ensure that families stay engaged and get the most out of the home visiting services you provide. A well-planned visit can help to relieve stress and anxiety for the home visitor, and can lead to many program benefits, such as an increase in home visit completion rate, referrals, and accuracy of assessments. A visit that is well prepared for is much more enjoyable for both the participant and home visitor.

*Presenters: Sara McCandlis and Amy Jo Grissom  
Healthy Families America  
Inspired Communities*

## C2: Attitude is Everything

**CORE COMPETENCY: PROFESSIONAL GROWTH & LEADERSHIP**

In many ways, we are alike: however, one little difference almost always makes a big difference. The little difference is attitude. The power of attitude is a significant characteristic of an educator. Always ask... Is my attitude worth catching? We must send positive messages. What do you want our message to be?

*Presenter: Dee Cox, Ed.D.  
Childcare Aware, NW AR*

## C3: Group Ease

**CORE COMPETENCY: PROFESSIONAL GROWTH & LEADERSHIP**

Group-ease is all about how to make your next and future group meetings fun, educational and easy.

*Presenters: Dr. Debbie Faubus-Kendrick, Dawn Lane and Lanea Yandell  
Parents as Teachers  
Van Buren School District*

## C5: Infant and Early Childhood Mental Health in Home Visiting

**CORE COMPETENCY: CHILD DEVELOPMENT**

This workshop will acquaint home visitors with principles of Infant and Early Childhood Mental Health, direct them to resources and tools, and include application to a home visit scenario.

*Presenters: Kelli Fly, M.S.  
Healthy Families America  
PSD/S21C Healthy Families America*

## C6: Managing Stress: Turning Challenges Into Blessings

**CORE COMPETENCY: HEALTH AND SAFETY**

Stress is an inevitable part of life. This workshop will help participant's identity challenges, recognize resources, turn those stresses into growth, and challenges into blessings.

*Presenters: Dr. Brittney Schrick and Rebecca Simon  
University of Arkansas Cooperative Extension*

## CONTINUING EDUCATION/ PROFESSIONAL DEVELOPMENT

1. All registered participants will receive a certificate of attendance (provided in your program)
2. Conference material will also include a **Training Documentation** form for participants to track their personal attendance. Labels will be provided at the end of each workshop. Code words will be provided at the General Sessions.
3. The conference has been registered with the Traveling Arkansas Professional Pathways Registry (TAPP) for the convenience of Registry members and the Arkansas Department of Education.
4. Participants may also request Continuing Education Units from A-State Childhood Services within 30 days of the conference (September 26, 2016).

### Information required:

CEU Request Form (a form has been provided in your program)  
Documented proof of training attendance (a certificate has been provided in your program)  
\$10.00 payable to A-State Childhood Services

### Mail check and form to:

A-State Childhood Services  
Attn: CEU Coordinator  
PO Box 2700  
State University, AR 72467

Requests made **AFTER** the conference for TAPP hours must be received on or before September 26, 2016

## CEU REQUEST FORM

You may request Continuing Education Units (CEUs) for this conference event. Please remember that ten (10) contact hours of training are equivalent to one (1) CEU.

To receive CEUs, send the following items to A-State Childhood Services by **September 26, 2016 (within 30 days of this event):**

- ✓ CEU request form
- ✓ Documented proof of training attendance (*examples include training certificate or TAPP transcript*)
- ✓ \$10.00 payable to A-State Childhood Services

Name \_\_\_\_\_

Address \_\_\_\_\_

City, State, Zip \_\_\_\_\_

Phone \_\_\_\_\_

Return required forms and payment **within 30 days** of this workshop to:

**A-State Childhood Services  
Attn: CEU Coordinator  
PO Box 2700  
State University, AR 72467**

*Office Use Only--  
Reference Account:  
131102 254751 554000 0000*

# Speaker Index

**Shanetta Agnew, MS**

Dental Care Coordinator  
Arkansas Department of Health–ConnectCare  
(501) 671-1530  
Shanetta.Agnew@arkansas.gov

**Donna Carter, M.Ed.**

Instructional Design Specialist  
Arkansas Home Visiting Network Training  
Institute, UAMS  
(501) 364-3482  
dlcarter@uams.edu

**Sarah Coleman, MA**

Coordinated Intake Manager  
Arkansas Children's Hospital  
(501) 364-5467  
frithse@archildrens.org

**Dee Cox, Ed.D.**

Training Specialist  
Childcare Aware, NW AR  
Training Specialist  
(501) 580-5666  
dee.cox53@yahoo.com

**Jenny Dura**

Research Associate; Training Advisor  
University of Arkansas, Early Care and  
Education Projects  
(479) 841-6408  
jheyer@uark.edu

**Debbie Faubus-Kendrick, Ed.D.**

Director  
Van Buren School District  
(479) 471-0019  
dfaibus@vbsd

**Kelli Fly, M.S.**

Family Support Specialist  
PSD/S21C Healthy Families America  
(870) 236-8064  
kfly@paragouldschools.net

**Amy Jo Grissom**

Program Coordinator  
Inspired Communities Foundation  
(870) 847-7880  
aj.inspiredcommunities@gmail.com

**Cathy Hagemeyer, M.Ed.**

MidSOUTH Training Academy,  
UALR School of Social Work  
(501) 296-1920  
cahagemeyer@midsouth.ualr.edu

**Reta Johnson, MS, CRC, CADC**

Community Outreach Program Manager  
Centers for Youth & Families  
(501) 660-6886 ext.3319  
rjohnson@cfyf.org

**Robin Jones, M.S.**

Training Advisor  
University of Arkansas Early Care and  
Education Projects  
(479) 841-6884  
rgcaudl@uark.edu

**Dawn Lane**

Parent Educator  
Van Buren School District  
(479) 471-0019  
dwhite@vbsd.us

**Laura Landrum**

Family Support Worker  
The Center's For Youth and Families  
(501) 660-6886 Ext: 3312  
LLandrum@cfyf.org

**Karen K. Lange, Ed.S.**

Director of the Outreach Support Services  
Arkansas School for the Deaf  
(501) 324-9522  
karenh@asd.k12.ar.us

**Sara McCandlis**

Home Visitor  
Inspired Communities Foundation  
(870) 219-5973  
sara.mccandlis@gmail.com

**Alan Mease, MD**

Medical Director, Child and Adolescent Health  
Arkansas Department of Health  
(501) 280-4761  
alan.mease@arkansas.gov

**Dee Parson, B.A.**

Child and Family Sciences  
HIPPI and Parents as Teachers Program  
Coordinator  
Arkansas Children's Hospital - Quitman  
HIPPI/PAT  
(501) 589-2168  
parsond@archildrens.com

**Ariel Schaufler, CHES**

Outreach Coordinator  
Arkansas Department of Health- ConnectCare  
(501) 671-1530  
Ariel.Schaufler@arkansas.gov

**Brittney Schrick, Ph.D.**

Assistant Professor - Family Life  
University of Arkansas Cooperative Extension  
(501) 671-2202  
bschrick@uaex.edu

**Rebecca Simon, M.S.**

U of A Cooperative Extension  
Program Associate- Early Childhood  
(501) 671-2364  
rsimon@uaex.edu

**Lanea Yandell**

Parent Educator  
Van Buren School District  
605 Alma Blvd Circle  
(479) 471-0019  
lanea.yandell@vbsd.us

# #AHVFN2016



# 2016 Conference Planning Committee

**Cheryl Anthes, RN**

Interim NFP Director  
Arkansas Department of Health

**Wanda Bradford-Corney**

Arkansas State HIPPY  
Arkansas Children's Hospital

**Donna L. Carter, M.Ed**

On-Line Training Developer  
Arkansas Home Visiting Network Training Institute  
UAMS

**Sarah Coleman, MA**

Coordinated Intake Manager  
Arkansas Home Visiting Network  
Arkansas Children's Hospital

**Tyra Greenwood, MS**

HIPPY, Director  
Arkansas State HIPPY  
Arkansas Children's Hospital

**Carmen Irby, MSN, RNP, CNS-BS**

Program Director  
Following Baby Back Home UAMS – KIDS FIRST

**Reta Johnson, MS, CRC, CADC**

Program Coordinator, Healthy Families America  
Centers for Youth and Families

**Jennie Kirby, MPA**

State PAT Director  
Arkansas Home Visiting Network  
Arkansas Children's Hospital

**Nicholas Long, Ph.D.**

Director  
Arkansas Home Visiting Network – Training Institute  
UAMS

**Felicia Loring, MS**

Trainer  
Arkansas Home Visiting Network – Training Institute  
UAMS

#AHVN2016

**Patty McCollum, MS**

Consultant, Healthy Families America  
MIECHV/Arkansas Home Visiting Network

**Jennifer Medley, MA**

Home Visiting Section Chief  
Arkansas Department of Health

**Kathy Pillow Price, Ed.D**

Director  
Arkansas Home Visiting Network  
Arkansas Children's Hospital

**Brad Planey, M.S., M.A.**

Branch Chief  
Family Health Branch  
Arkansas Department of Health

**Sue Porbeck, BS, CHES**

Project Coordinator  
Arkansas Home Visiting Network – Training Institute  
UAMS

**Leslie Rush, MSE**

Instructor Led Training Developer  
Arkansas Home Visiting Network – Training Institute  
UAMS

**Alice Story, MPH, JM**

MIECHV Grants Coordinator  
Arkansas Department of Health

**Jo Ella Vick**

Home Visitor  
Arkansas State HIPPY  
Arkansas Children's Hospital



**August 25-26, 2016**



**Stronger Families.  
Brighter Futures.**

ARKANSAS HOME VISITING NETWORK

**CERTIFICATE OF ATTENDANCE**

---

# 2016 Arkansas Home Visiting Network Conference

*“Celebrating Stronger Families Brighter Futures”*

\_\_\_\_\_  
Total Hours Completed  
(Maximum of 6 hours)



Nicholas Long, PhD, Director  
Arkansas Home Visiting Network Training Institute

TAPP #55966  
ADE ID# 63390616000000

# Meeting Rooms

## Embassy Suites • Little Rock

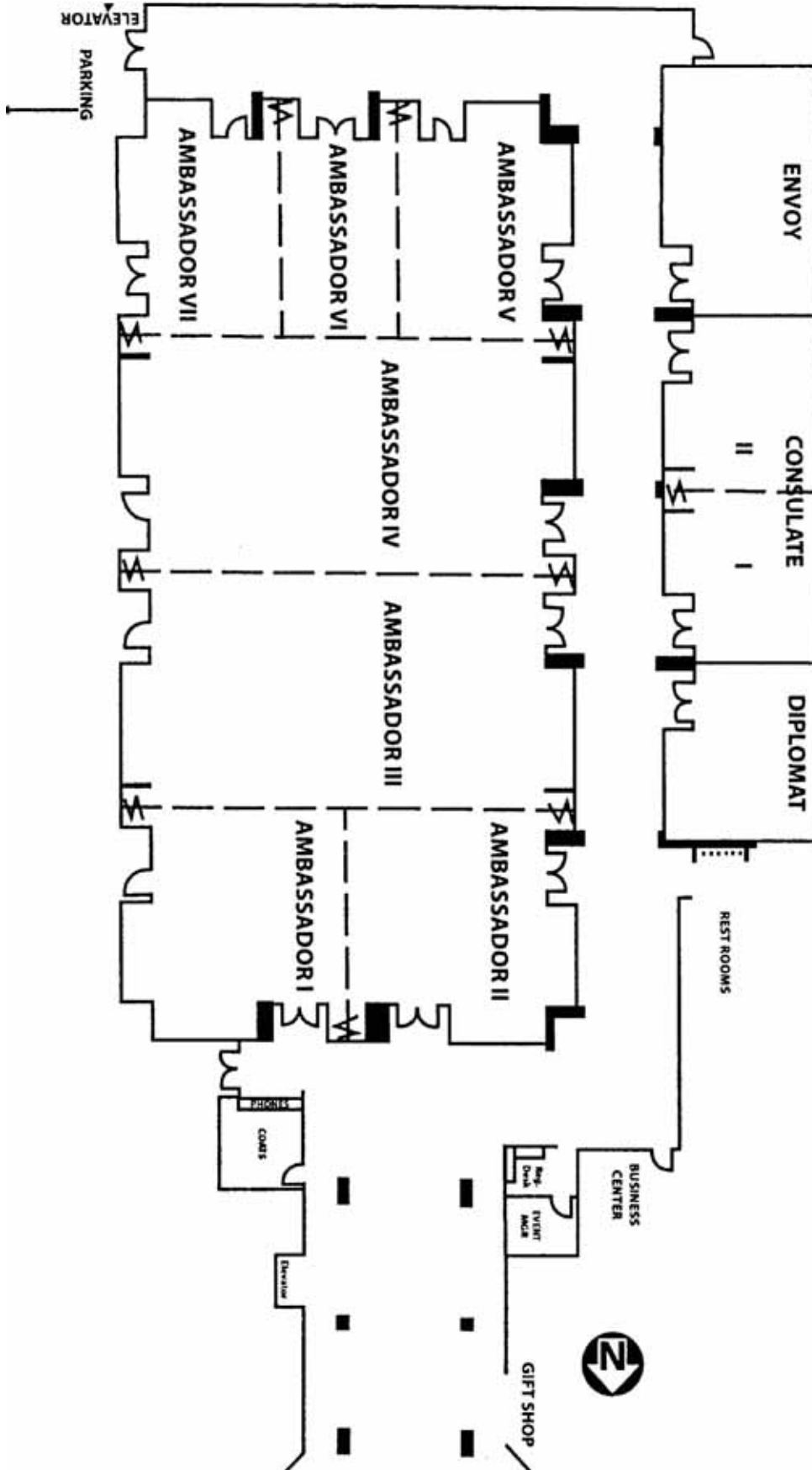

Stronger Families.  
Brighter Futures.

ARKANSAS HOME VISITING NETWORK



Arkansas Department of Health  
Keeping Your Hometown Healthy

*Funding for this conference was made possible by the Health Resources and Services Administration (HRSA) of the U.S. Department of Health and Human Services (HHS under grant number D89MC23141 of the Affordable Care Act - Maternal, Infant, and Early Childhood Home Visiting Program awarded to the Arkansas Department of Health. The information or content and conclusions expressed in conference materials or by speakers and moderators are those of the author(s) and should not be construed as the official position or policy of, nor should any endorsements be inferred by HRSA, HHS, or the U.S. Government.*